



## Boost your sales with the most versatile banner display

### A visual impact in just a few steps.

The assembly of the duo.sprint is reduced to the minimum. One minute to open the carry case, put up the pole, attach the graphic and adjust the height. This is fast - very fast - without tools or parts to fit together.

The duo.sprint is a banner stand with a telescopic pole that can reach a height of 118". Several widths and heights are possible to display single or double-sided graphics on the same frame, or to use rigid or flexible substrates. The duo.sprint comes with accessories such as brochure holders and/or lights.

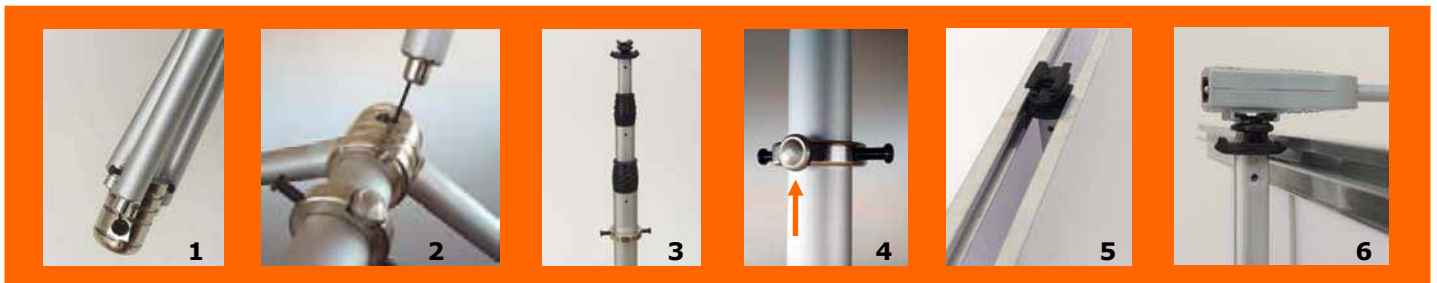
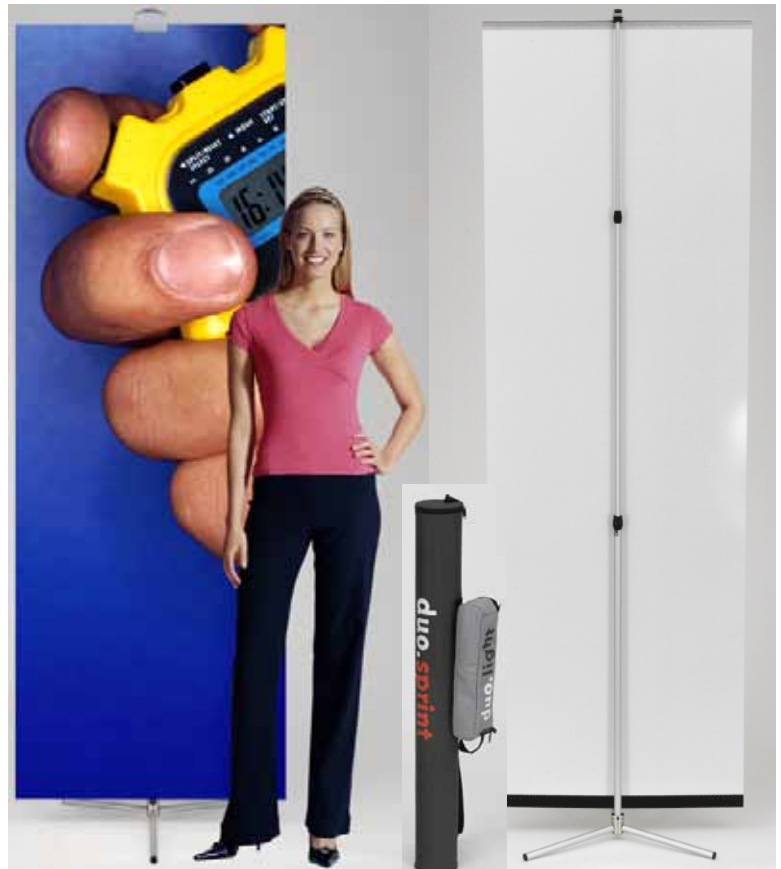

1. The tripod feet are linked with bungee cord for quick, simple and secure automatic set-up.
2. The high-precision undercutting steel node is essential for a necessary weight that brings balance and overall steadiness.
3. The state of the art spin-lock mechanism on the telescopic pole allows easy height adjustment without tools. The easy grip plastic twist locks prevent the pole from sliding down once extended.
4. The adjustable ring is a sliding part on the pole secured without any tool thanks to the locking screw. Easy to handle and adjust, the ring offers a great versatility in graphics sizes.
5. The head of the pole can easily hang single or double sided graphics.
6. The floodlight can be inserted on the special groove located on the head of the pole.

## YOU DESERVE THE ORIGINAL!

### One frame for infinite applications



Standard widths:  
23 5/8", 31 1/2", 39 3/8", 47 1/4"

Double-sided  
graphic panels

Variable widths  
and lengths

Floodlight  
solutions

Custom-shaped graphics  
or rigid panels

### It is not a luxury to count on THE ORIGINAL duo.sprint



Literature holders or shelves

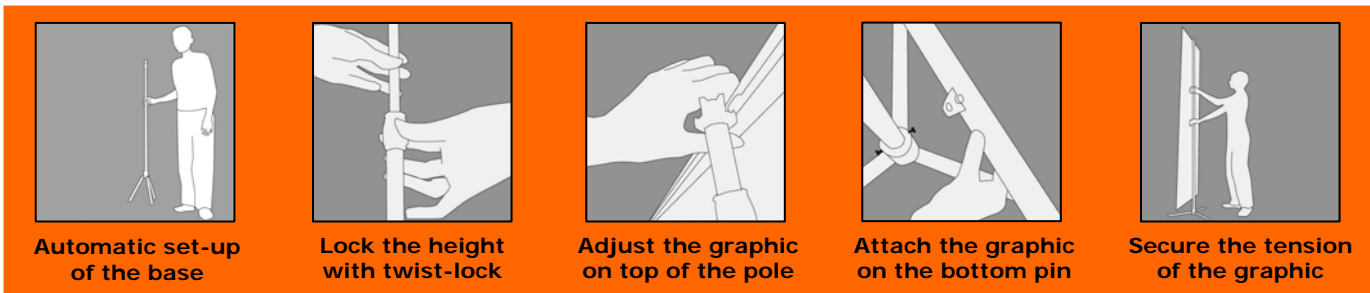

Automatic set-up  
of the base

Lock the height  
with twist-lock

Adjust the graphic  
on top of the pole

Attach the graphic  
on the bottom pin

Secure the tension  
of the graphic

duo.sprint 3				
Pole	3-part telescopic pole			
Height	up to 118"			
Width	23 5/8"	31 1/2"	39 3/8"	47 1/4"
Weight	lbs. 3.75	lbs. 4.19	lbs. 4.63	lbs. 5.07
Tube (length)	44 5/16"	44 5/16"	44 5/16"	48 1/4"
Set-up time	2 min			
Change of graphic	1 min			
Base	3 bungee-corded 17 3/4" feet in steel hub			
Hardware material	Anodized aluminum			
Graphic option	Single and double-sided			
Graphic material	Any kind (paper, laminate, vinyl, fabric, canvas, rigid substrate)			
Packaging	Polyester & cardboard Bag (44 1/2" or 48")			

